



Insynctive® INTEGRATED ENTRY DOOR SENSORS



INTEGRATED ENTRY DOOR SENSORS communicate the opened or closed and locked or unlocked status of your Entry Door by Pella to **BRIDGE**.

WHAT'S NEEDED:

- **PELLA® INSYNCTIVE® BRIDGE (required – sold separately):** Wirelessly connects your Insynctive products to STATUS INDICATOR or a compatible home automation system.*
- **PELLA INSYNCTIVE STATUS INDICATOR (optional – sold separately):** Indicates status of Pella Insynctive SENSORS. Or you can use a compatible home automation system to help monitor your windows and doors.*
- **SMALL FLATHEAD SCREWDRIVER**

* For a list of compatible home automation systems, visit [Insynctive.Pella.com](https://www.insynctive.pella.com).

TABLE OF CONTENTS

3	General and Safety Information <ul style="list-style-type: none">■ Registering Products■ Need Help?■ Have a Home Automation System?■ Warnings
4	Product Overview <ul style="list-style-type: none">■ Specifications
5	Detailed Instructions <ul style="list-style-type: none">■ Integrated Sensor Setup for Entry Door from Pella with Deadbolt Lock■ Integrated Sensor Setup for Entry Door from Pella with Multipoint Lock
13	Additional Instructions <ul style="list-style-type: none">■ Product Manufacturer's Code■ Care and Maintenance■ Replacing Batteries■ Deleting Sensors
19	Troubleshooting
20	FCC Compliance and Industry Canada
21	Limited Warranty
	Software License Agreement and Privacy Policy

GENERAL AND SAFETY INFORMATION

REGISTERING PRODUCTS

Visit **Insynctive.Pella.com/Registration** to register your new Pella® Insynctive® products.

NEED HELP?

For instant access to warranties, troubleshooting information and videos, visit **Insynctive.Pella.com/Support** or call **855-473-5524**.

HAVE A HOME AUTOMATION SYSTEM?

To view a list of compatible systems and find instructions on how to sync Pella Insynctive products, visit **Insynctive.Pella.com**.

WARNING

Failure to adhere to the warnings below may result in death, serious injury and/or loss of valuables.

- Pella Insynctive INTEGRATED ENTRY DOOR SENSORS are not 100% reliable for a variety of reasons. For example, SENSORS:
 - communicate data wirelessly, and wireless data is susceptible to interference or failure.
 - require proper installation.
 - require a battery with an adequate charge.
 - may indicate a locked status when a door is not completely closed.
 - may be damaged after installation.

Therefore, Pella Insynctive products should not be relied upon in situations where life, safety and/or protection of valuables are solely dependent on their function. Test each product at least once per year to help ensure proper operation.

- Pella Insynctive products are not a substitute for careful adult supervision of children.
- Keep battery and other small parts out of the reach of children. If small parts are swallowed, immediately seek medical help.
- Batteries carry the risk of fire, explosion and burns. Do not recharge, disassemble or incinerate.
- INTEGRATED ENTRY DOOR SENSORS may indicate an entry door is closed but water intrusion may occur during rain. Entry doors should be closed and locked for optimal performance in rain.

PRODUCT OVERVIEW

INTEGRATED ENTRY DOOR SENSORS wirelessly communicate the locked or unlocked and opened or closed status of Entry Doors by Pella to Insynctive® BRIDGE.

Information is wirelessly relayed from BRIDGE to STATUS INDICATOR or a compatible home automation system,* where locked or unlocked and opened or closed status can be monitored.

Sensors are integrated into Entry Doors by Pella ordered with Insynctive technology, making them virtually unnoticeable.

* For a list of compatible home automation systems, visit Insynctive.Pella.com.

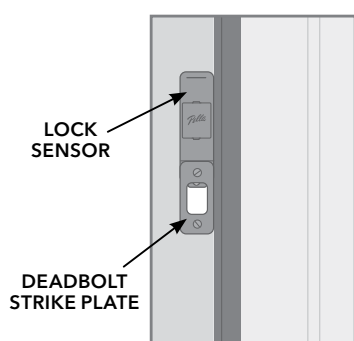

DOOR JAMB

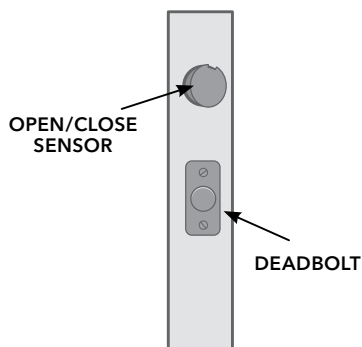

DOOR PANEL

INTEGRATED SENSORS FOR ENTRY DOOR
WITH DEADBOLT LOCK

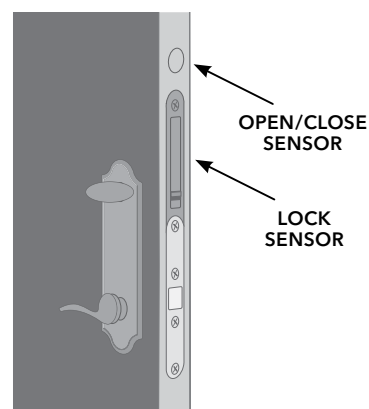

DOOR PANEL

INTEGRATED SENSORS FOR ENTRY DOOR
WITH MULTIPOINT LOCK

SPECIFICATIONS

Frequency: 433.92MHz (Insynctive)

Operating Temperature: -22° to 140°F (-30° to 60°C)

Operating Humidity: 5% to 95% RH noncondensing

Lock Sensor Battery: 3V lithium CR2032

Open/Close Sensor Battery: 3V lithium CR2

Typical Battery Life: 10 years (based on operating temperatures of 32° to 120°F [0° to 49°C], may vary by use)

Magnet Gap: 1/4" max between door panel and lock jamb

DETAILED INSTRUCTIONS

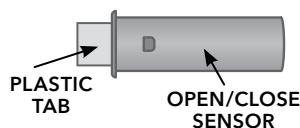
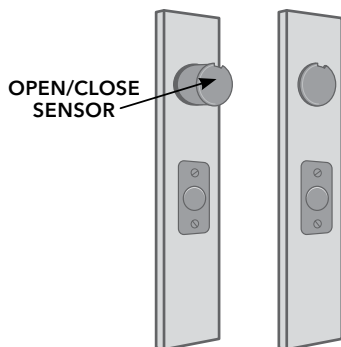
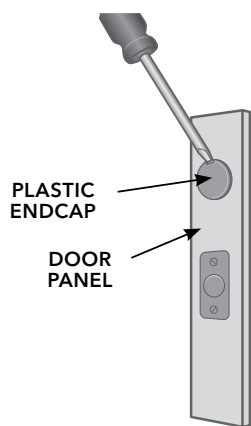
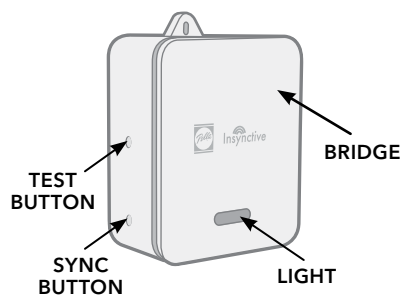

INTEGRATED SENSOR SETUP for Entry Door by Pella with Deadbolt Lock

See [Insynctive.Pella.com/Support](https://www.insynctive.pella.com/Support) for how-to videos.

1. Get Started

Plug BRIDGE into an electrical outlet (light will turn green and then flash blue).

2. Prepare OPEN/CLOSE SENSOR

Use a small flathead screwdriver to remove the plastic endcap from OPEN/CLOSE SENSOR. Remove the plastic tab from the battery, then install the plastic endcap back onto OPEN/CLOSE SENSOR.

NOTE: Once the plastic tab is removed from the battery, you will have 2 minutes to sync your OPEN/CLOSE SENSOR to BRIDGE. If 2 minutes pass without successfully syncing, follow steps on page 13 to remove and reinsert the battery.

You are ready to sync OPEN/CLOSE SENSOR to BRIDGE.

3. Sync OPEN/CLOSE SENSOR to BRIDGE

Each INTEGRATED ENTRY DOOR SENSOR will need to be synced to BRIDGE.

WITHOUT HOME AUTOMATION (Stand-Alone Mode)

Press and hold BRIDGE Sync button until light begins flashing orange. The Sync button is the bottom button located on the side of BRIDGE.

NOTE: BRIDGE is in sync mode while the orange light is flashing. BRIDGE will remain in sync mode for 2 minutes. BRIDGE will then beep, and orange light will turn off to indicate BRIDGE exited sync mode.

DETAILED INSTRUCTIONS (continued)

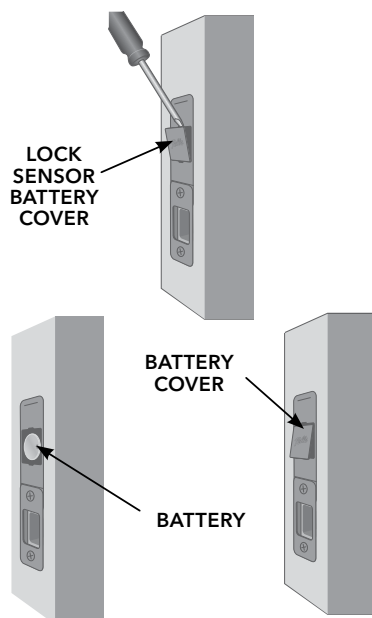
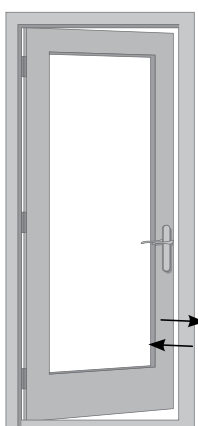
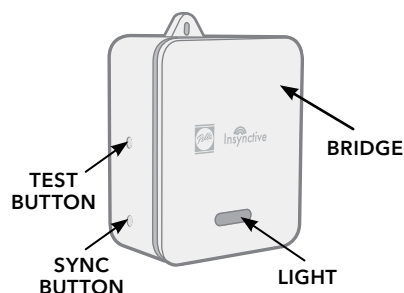

To sync OPEN/CLOSE SENSOR to BRIDGE, open then close your entry door twice within 5 seconds.

Wait for the light on BRIDGE to flash green and beep for 2 seconds. This will indicate a successful sync.

If OPEN/CLOSE SENSOR sync is unsuccessful, return to Step 2 and retry the process.

4. Prepare LOCK SENSOR

Use a small flathead screwdriver to remove the battery cover on LOCK SENSOR. Carefully remove the battery with the flathead screwdriver.

Remove the plastic tab separating the battery from LOCK SENSOR. Ensure the battery is properly installed. Replace battery cover on LOCK SENSOR.

NOTE: Once the plastic tab is removed from the battery, you will have 2 minutes to sync your LOCK SENSOR to BRIDGE. If 2 minutes pass without successfully syncing, remove and insert the battery again.

You are ready to sync LOCK SENSOR to BRIDGE.

5. Sync LOCK SENSOR to BRIDGE

Each INTEGRATED ENTRY DOOR SENSOR will need to be synced to BRIDGE.

WITHOUT HOME AUTOMATION (Stand-Alone Mode)

Press and hold BRIDGE Sync button until light begins flashing orange. The Sync button is the bottom button located on the side of BRIDGE.

DETAILED INSTRUCTIONS (continued)

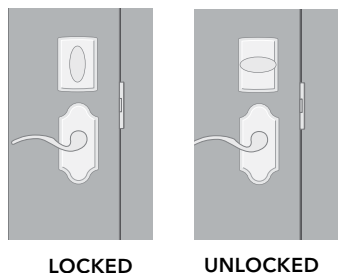
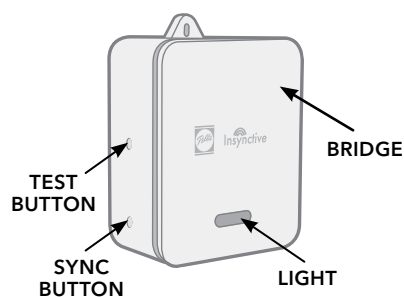

NOTE: BRIDGE is in sync mode while the orange light is flashing. BRIDGE will remain in sync mode for 2 minutes. BRIDGE will then beep, and orange light will turn off to indicate BRIDGE exited sync mode.

To sync LOCK SENSOR to BRIDGE, ensure that your entry door is closed and locked; then unlock and lock your door 2 times within 5 seconds.

Wait for the light on BRIDGE to flash green and beep for 2 seconds. This will indicate a successful sync.

If LOCK SENSOR sync is unsuccessful, return to Step 2 and retry the process.

Repeat the previous steps until all INTEGRATED ENTRY DOOR SENSORS have been synced to BRIDGE.

To exit sync mode, press and hold Sync button on BRIDGE until light stops flashing orange.

WITH HOME AUTOMATION

BRIDGE supports two types of home automation systems, Professionally Installed and Do-It-Yourself (DIY) Z-Wave. For a list of compatible home automation systems or syncing instructions, visit **[Insynctive.Pella.com](https://www.insynctive.com/pella)**.

DETAILED INSTRUCTIONS (continued)

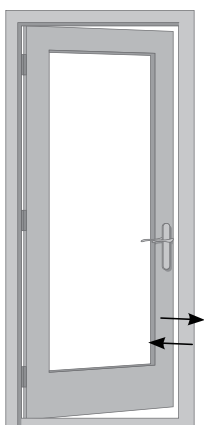
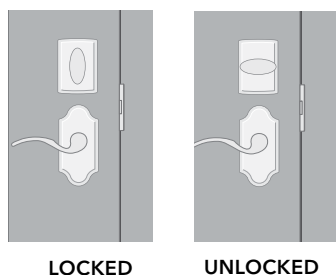
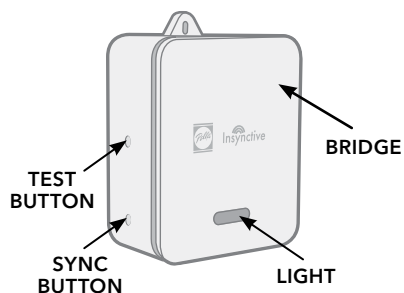

6. Test INTEGRATED ENTRY DOOR SENSORS

Each INTEGRATED ENTRY DOOR SENSOR should be tested to ensure proper function after it is synced.

To test LOCK SENSOR, use the following procedure:

Unlock your entry door and verify that LOCK SENSOR reports the product as unlocked on your STATUS INDICATOR or compatible home automation system. BRIDGE will beep twice.

To test OPEN/CLOSE SENSOR, use the following procedure:

Open your entry door and verify that OPEN/CLOSE SENSOR reports the product as opened on your STATUS INDICATOR or compatible home automation system. BRIDGE will beep twice.

If any of these steps fail, see the troubleshooting information on page 19.

NOTE: If you have selected the chimes to be off, BRIDGE will not beep. See Bridge Product Guide for information on setting up chimes.

DETAILED INSTRUCTIONS (continued)

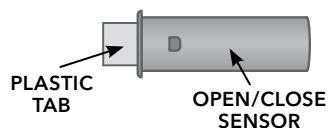
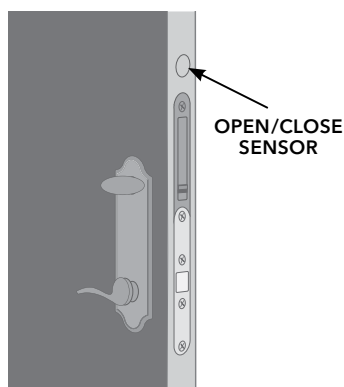
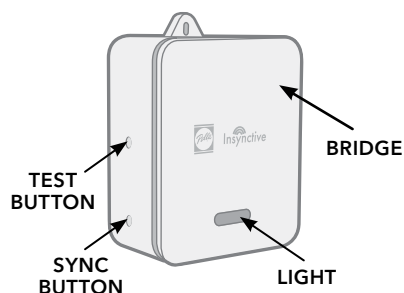

INTEGRATED SENSOR SETUP for Entry Door by Pella with Multipoint Lock

See [Insynctive.Pella.com/Support](https://www.insynctive.com/support) for how-to videos.

1. Get Started

Plug BRIDGE into an electrical outlet (light will turn green and then flash blue).

2. Prepare OPEN/CLOSE SENSOR

Use a small flathead screwdriver to remove the plastic endcap from OPEN/CLOSE SENSOR. Remove the plastic tab from the battery, then install the plastic endcap back onto OPEN/CLOSE SENSOR.

NOTE: Once the plastic tab is removed from the battery, you will have 2 minutes to sync your OPEN/CLOSE SENSOR to BRIDGE. If 2 minutes pass without successfully syncing, follow steps on page 13 to remove and reinsert the battery.

You are ready to sync OPEN/CLOSE SENSOR to BRIDGE.

3. Sync OPEN/CLOSE SENSOR to BRIDGE

Each INTEGRATED ENTRY DOOR SENSOR will need to be synced to BRIDGE.

WITHOUT HOME AUTOMATION (Stand-Alone Mode)

Press and hold BRIDGE Sync button until light begins flashing orange. The Sync button is the bottom button located on the side of BRIDGE.

NOTE: BRIDGE is in sync mode while the orange light is flashing. BRIDGE will remain in sync mode for 2 minutes. BRIDGE will then beep, and orange light will turn off to indicate BRIDGE exited sync mode.

To sync OPEN/CLOSE SENSOR to BRIDGE, open then close your entry door twice within 5 seconds.

Wait for the light on BRIDGE to flash green and beep for 2 seconds. This will indicate a successful sync.

If OPEN/CLOSE SENSOR sync is unsuccessful, return to Step 2 and retry the process.

DETAILED INSTRUCTIONS (continued)

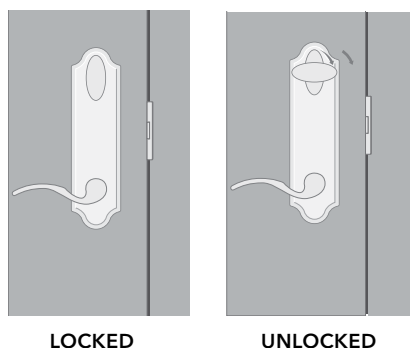
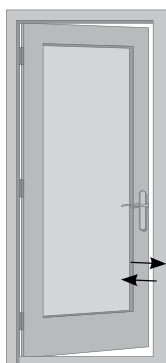
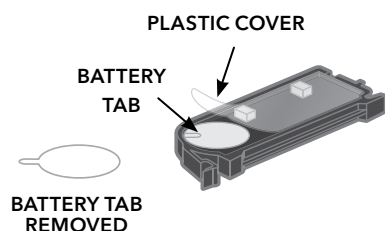
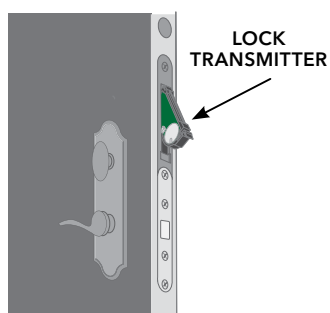
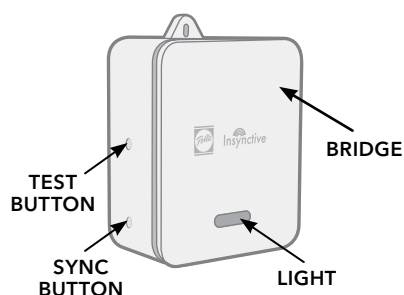

4. Prepare LOCK SENSOR

This lock transmitter is used in multiple INTEGRATED SENSORS units. The lock transmitter must learn what type of entry door it will be housed in. Follow the steps below to prep the lock transmitter.

Remove the lock transmitter from the door, and lift up a corner of the plastic cover to expose the battery.

Remove the plastic tab separating the battery from the device. Push down on the battery to ensure that the battery is firmly in place. Make sure plastic cover is flat and in place.

NOTE: Once the plastic tab is removed from the battery, you will have 2 minutes for your lock transmitter to learn what type of door it will be housed in. If 2 minutes pass without the transmitter successfully learning your door type, follow steps for removing and reinserting the battery on page 14.

Insert the lock transmitter back into your entry door; close and lock the door, then wait 10 seconds. The lock transmitter has now learned what type of door it is housed in.

You are ready to sync LOCK SENSOR to BRIDGE.

5. Sync LOCK SENSOR to BRIDGE

Each INTEGRATED ENTRY DOOR SENSOR will need to be synced to BRIDGE. You will have 2 minutes after completing Step 4 to complete this step. If syncing is not successful within 2 minutes, remove then replace the battery and repeat steps 4 and 5.

DETAILED INSTRUCTIONS (continued)

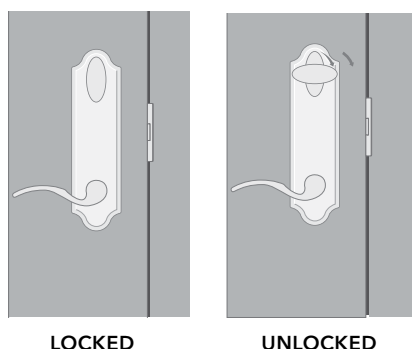
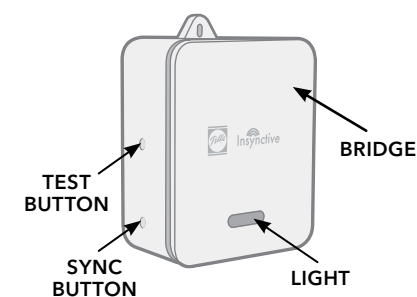

WITHOUT HOME AUTOMATION (Stand-Alone Mode)

Press and hold BRIDGE Sync button until light begins flashing orange. The Sync button is the bottom button located on the side of BRIDGE.

NOTE: BRIDGE is in sync mode while the orange light is flashing. BRIDGE will remain in sync mode for 2 minutes. BRIDGE will then beep, and orange light will turn off to indicate BRIDGE exited sync mode.

To sync LOCK SENSOR to BRIDGE, unlock then lock your entry door 2 times within 10 seconds.

Wait for the light on BRIDGE to flash green and beep for 2 seconds. This will indicate a successful sync.

If LOCK SENSOR sync is unsuccessful, unlock then lock your entry door 2 more times within 10 seconds. Then wait until BRIDGE indicates a successful sync.

Repeat the previous steps until all INTEGRATED ENTRY DOOR SENSORS have been synced to BRIDGE.

To exit sync mode, press and hold Sync button on BRIDGE until light stops flashing orange.

DETAILED INSTRUCTIONS (continued)

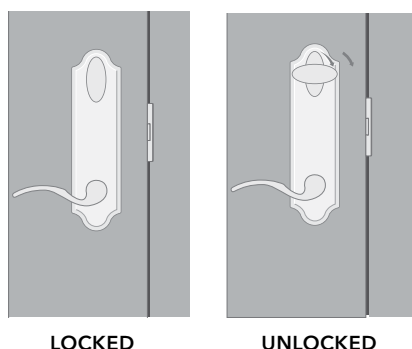
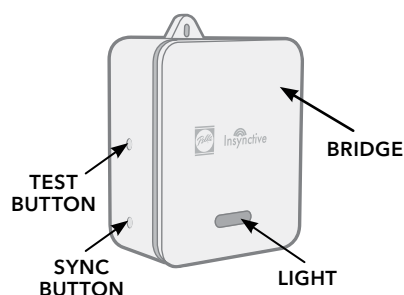

WITH HOME AUTOMATION

BRIDGE supports two types of home automation systems, Professionally Installed and Do-It-Yourself (DIY) Z-Wave. For a list of compatible home automation systems or syncing instructions, visit [Insynctive.Pella.com](https://www.insynctive.com).

6. Test INTEGRATED ENTRY DOOR SENSORS

Each INTEGRATED ENTRY DOOR SENSOR should be tested to ensure proper function after it is synced.

To test LOCK SENSOR, unlock your entry door and verify that LOCK SENSOR reports the product as unlocked on your STATUS INDICATOR or compatible home automation system. BRIDGE will beep twice.

To test OPEN/CLOSE SENSOR, open your entry door and verify that OPEN/CLOSE SENSOR reports the product as opened on your STATUS INDICATOR or compatible home automation system. BRIDGE will beep twice.

If any of these steps fail, see the troubleshooting information on page 19.

NOTE: If you have selected the chimes to be off, BRIDGE will not beep. See Bridge Product Guide for information on setting up chimes.

ADDITIONAL INSTRUCTIONS

PRODUCT CODE



LOCK SENSOR FOR ENTRY DOOR BY PELLA
WITH DEADBOLT LOCK

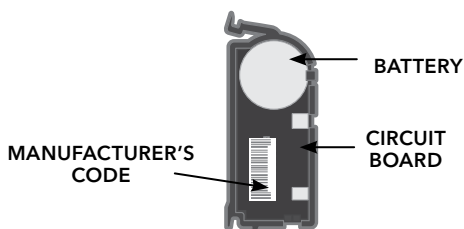

LOCK SENSOR FOR ENTRY DOOR BY PELLA
WITH MULTIPOINT LOCK

PRODUCT CODE

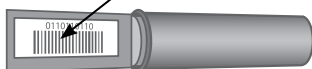

OPEN/CLOSE SENSOR

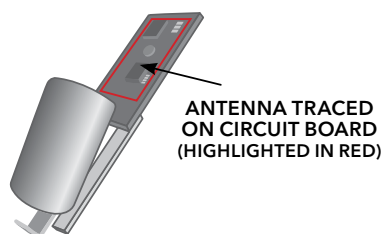
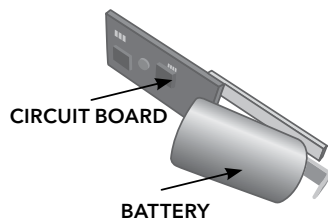
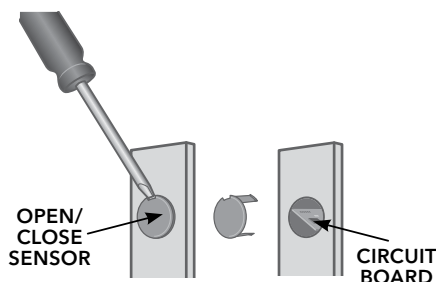

HOW TO FIND PRODUCT MANUFACTURER'S CODE

Each Pella® Insynctive® product contains a label with a Manufacturer's Code that will be required to help Pella Customer Service identify the product if service is required. To locate the Manufacturer's Code for LOCK SENSOR for Entry Door by Pella with Deadbolt Lock, remove LOCK SENSOR from the jamb and look at the sticker on the back of the device. To locate the Manufacturer's Code for LOCK SENSOR for Entry Door by Pella with Multipoint Lock, pull lock transmitter from your entry door. The label is on the circuit board next to the battery. To locate the Manufacturer's Code for OPEN/CLOSE SENSOR, remove the battery cover and carefully pull out the circuit board. The sticker will be located on the circuit board.

NOTE: Electrostatic-sensitive. Avoid touching the antenna or circuit board when accessing the Manufacturer's Code.

CARE AND MAINTENANCE

- Test Insynctive products at least once per year to help ensure proper operation.
- Do not paint over SENSORS.

REPLACING BATTERIES

See [Insynctive.Pella.com/Support](https://www.insynctive.pella.com/Support) for how-to videos.

When INTEGRATED ENTRY DOOR SENSOR battery is low, a signal will be sent to BRIDGE. To aid in identifying which SENSOR has a low battery, BRIDGE will beep twice and then issue a long tone when INTEGRATED ENTRY DOOR SENSOR with the low battery changes from locked to unlocked or opened to closed.

To replace the battery on OPEN/CLOSE SENSOR:

- Use a flathead screwdriver to carefully remove the plastic endcap from the OPEN/CLOSE SENSOR.
- Grip the edges of the circuit board and pull it out to gain access to the battery.
- Carefully slide out the battery and replace with a CR2 battery.
- Slide circuit board back inside SENSOR and install the plastic endcap back onto the SENSOR.
- Wait 2 minutes, then test SENSOR by opening the entry door with installed SENSOR. BRIDGE should beep twice. Resyncing SENSOR is not required after battery change.

ADDITIONAL INSTRUCTIONS (continued)

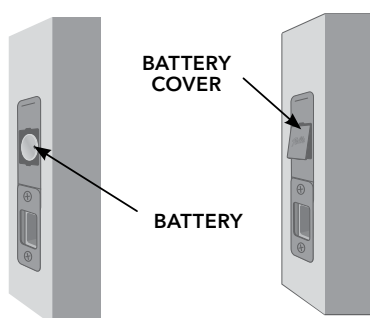
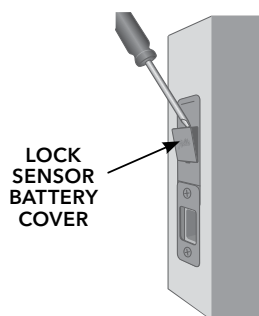

ENTRY DOOR BY PELLA
WITH DEADBOLT LOCK

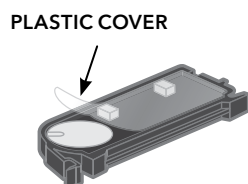
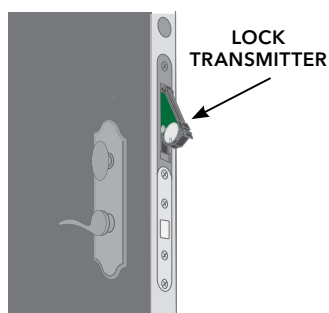

ENTRY DOOR FROM PELLA
WITH MULTIPOINT LOCK

To replace the battery on LOCK SENSOR for Entry Door by Pella with Deadbolt Lock:

- Use a flathead screwdriver to carefully remove the battery cover from LOCK SENSOR.
- Carefully remove the battery and replace with a CR2 battery.
- Install the battery cover back onto SENSOR.
- Wait 2 minutes, then test SENSOR by locking then unlocking the entry door with installed SENSOR. BRIDGE should beep twice when unlocked. Resyncing SENSOR is not required after battery change.

To replace the battery on LOCK SENSOR for Entry Door by Pella with Multipoint Lock:

- Remove the lock transmitter from your entry door, then lift up the corner of the plastic cover to reveal the battery.
- Carefully replace with a CR2032 battery, ensuring that the plus (+) side of the battery faces toward you.
- Replace clear plastic cover over battery and ensure that battery is seated, then insert lock transmitter back into your entry door.
- Close and lock the door within 2 minutes of replacing the battery to teach SENSOR what type of product it is installed in.
- Wait 2 minutes, then test SENSOR by unlocking your entry door with installed SENSOR. BRIDGE should beep twice. Resyncing SENSOR is not required after battery change.



WARNING: Batteries carry the risk of fire, explosion and burns. Do not recharge, disassemble or incinerate.

IMPORTANT NOTES:

- Electrostatic-sensitive. Avoid touching the antenna or circuit board when changing the battery.
- Failure to change battery promptly when low will impair SENSOR performance.
- Properly dispose of used batteries based on your local requirements. A best practice is to dispose of batteries at your local home chemical collection center. **California Only:** Contains perchlorate material. See dtsc.ca.gov/hazardouswaste/perchlorate for any special handling regulations.

ADDITIONAL INSTRUCTIONS (continued)

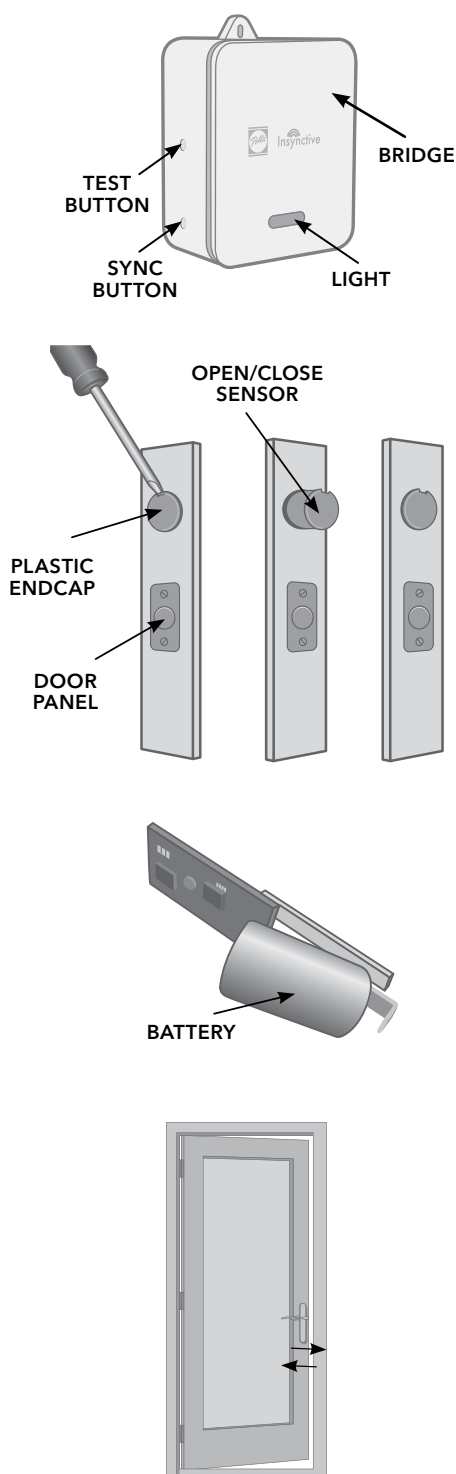

DELETING INTEGRATED SENSOR for Entry Door by Pella with Deadbolt Lock

Deleting INTEGRATED ENTRY DOOR SENSORS may be needed if you no longer have a use for INTEGRATED ENTRY DOOR SENSORS. See [Insynctive.Pella.com/Support](https://www.insynctive.com/Pella.com/Support) for how-to-videos.

1. Prepare OPEN/CLOSE SENSOR

Use a small flathead screwdriver to remove the plastic endcap from OPEN/CLOSE SENSOR. Grip the edges of the circuit board and pull it out to gain access to the battery. Slide out the battery, then slide it back in, then reinsert OPEN/CLOSE SENSOR into your entry door. Install the plastic endcap back onto OPEN/CLOSE SENSOR.

NOTE: Once the battery is removed, you will have 2 minutes to delete your OPEN/CLOSE SENSOR from BRIDGE. If 2 minutes pass without successful deletion, remove and insert the battery again.

You are ready to delete OPEN/CLOSE SENSOR from BRIDGE.

2. Delete OPEN/CLOSE SENSOR from BRIDGE

WITHOUT HOME AUTOMATION (Stand-Alone Mode)

Press and hold BRIDGE Sync button until light begins flashing orange. The Sync button is the bottom button located on the side of BRIDGE.

NOTE: BRIDGE is in sync mode while the orange light is flashing. BRIDGE will remain in sync mode for 2 minutes. BRIDGE will then beep, and orange light will turn off to indicate BRIDGE exited sync mode.

To delete OPEN/CLOSE SENSOR from BRIDGE, open then close your entry door twice within 5 seconds.

Wait for the light on BRIDGE to flash red and beep 3 times. This will indicate a successful deletion.

If OPEN/CLOSE SENSOR deletion is unsuccessful, return to Step 1 and retry the process.

ADDITIONAL INSTRUCTIONS (continued)

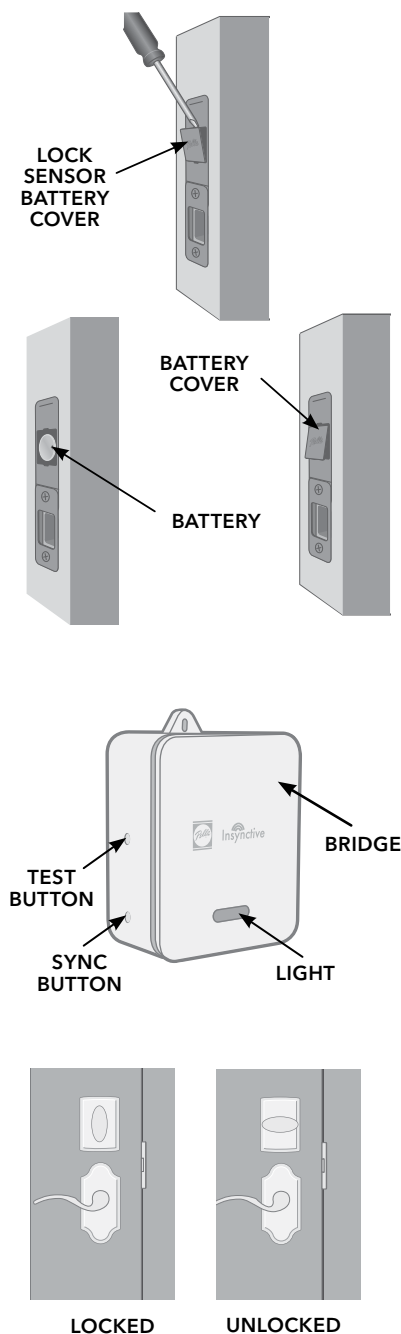

3. Prepare LOCK SENSOR

Use a small flathead screwdriver to remove the battery cover on LOCK SENSOR. Carefully remove and replace the battery. Ensure the battery is correctly installed. Replace battery cover on SENSOR.

NOTE: Once the battery is removed, you will have 2 minutes to delete your LOCK SENSOR from BRIDGE. If 2 minutes pass without successful deletion, remove and insert the battery again.

You are ready to delete INTEGRATED LOCK SENSOR from BRIDGE.

4. Delete LOCK SENSOR

Each INTEGRATED ENTRY DOOR SENSOR will need to be deleted from BRIDGE.

WITHOUT HOME AUTOMATION (Stand-Alone Mode)

Press and hold BRIDGE Sync button until light begins flashing orange. The Sync button is the bottom button located on the side of BRIDGE.

NOTE: BRIDGE is in sync mode while the orange light is flashing. BRIDGE will remain in sync mode for 2 minutes. BRIDGE will then beep, and orange light will turn off to indicate BRIDGE exited sync mode.

To delete LOCK SENSOR from BRIDGE, ensure your entry door is closed and locked; then unlock and lock your door 2 times within 10 seconds.

Wait for the light on BRIDGE to flash red and beep 3 times. This will indicate a successful deletion.

If LOCK SENSOR deletion is unsuccessful, return to Step 3 and retry the process.

Repeat the previous steps until all INTEGRATED ENTRY DOOR SENSORS have been deleted from BRIDGE.

To exit sync mode, press and hold Sync button on BRIDGE until light stops flashing orange.

WITH HOME AUTOMATION

BRIDGE supports two types of home automation systems, Professionally Installed and Do-It-Yourself (DIY) Z-Wave. Visit **Insynctive.Pella.com** for a list of compatible home automation systems and deletion instructions.

ADDITIONAL INSTRUCTIONS (continued)

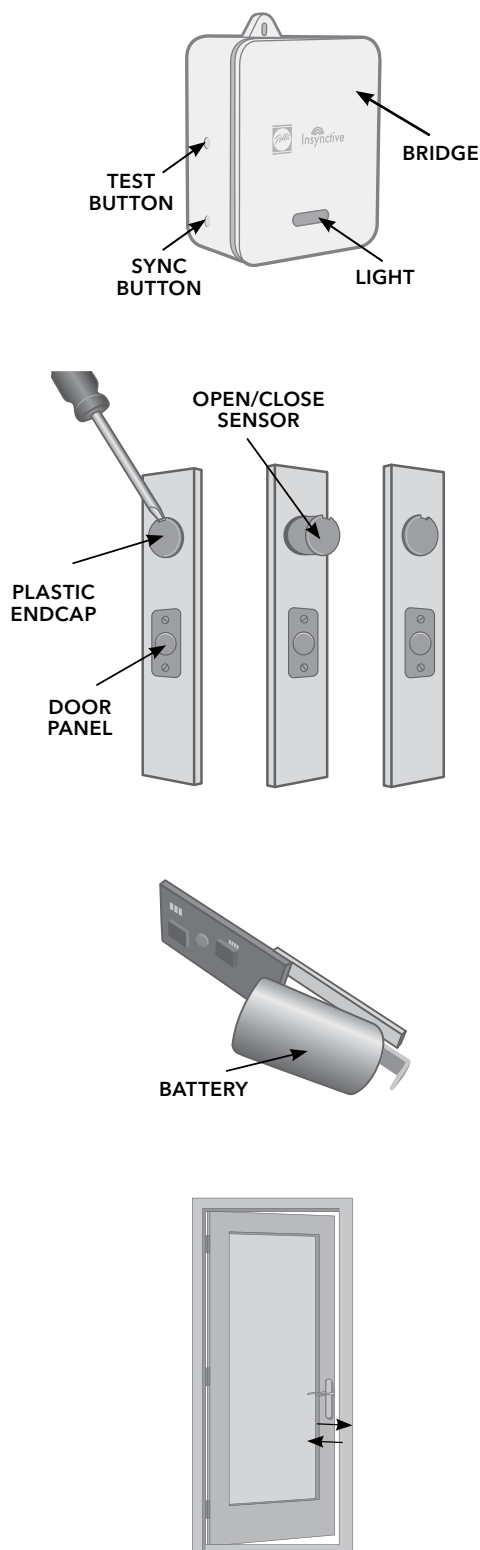

DELETING INTEGRATED SENSOR for Entry Door by Pella with Multipoint Lock

Deleting INTEGRATED ENTRY DOOR SENSORS may be needed if you no longer have a use for INTEGRATED ENTRY DOOR SENSORS. See [Insynctive.Pella.com/Support](https://www.insynctive.pella.com/Support) for how-to videos.

1. Prepare OPEN/CLOSE SENSOR

Use a small flathead screwdriver to remove the plastic endcap from OPEN/CLOSE SENSOR. Grip the edges of the circuit board and pull it out to gain access to the battery. Slide out the battery, then slide it back in, then reinsert OPEN/CLOSE SENSOR into your entry door. Install the plastic endcap back onto OPEN/CLOSE SENSOR.

NOTE: Once the battery is removed, you will have 2 minutes to delete your OPEN/CLOSE SENSOR from BRIDGE. If 2 minutes pass without successful deletion, remove and insert the battery again.

You are ready to delete OPEN/CLOSE SENSOR from BRIDGE.

2. Delete OPEN/CLOSE SENSOR from BRIDGE

Each INTEGRATED ENTRY DOOR SENSOR will need to be deleted from BRIDGE.

WITHOUT HOME AUTOMATION (Stand-Alone Mode)

Press and hold BRIDGE Sync button until light begins flashing orange. The Sync button is the bottom button located on the side of BRIDGE.

NOTE: BRIDGE is in sync mode while the orange light is flashing. BRIDGE will remain in sync mode for 2 minutes. BRIDGE will then beep, and orange light will turn off to indicate BRIDGE exited sync mode.

To delete OPEN/CLOSE SENSOR from BRIDGE, open then close your entry door 2 times within 5 seconds.

Wait for the light on BRIDGE to flash red and beep 3 times. This will indicate a successful deletion.

If OPEN/CLOSE SENSOR deletion is unsuccessful, return to Step 1 and retry the process.

ADDITIONAL INSTRUCTIONS (continued)

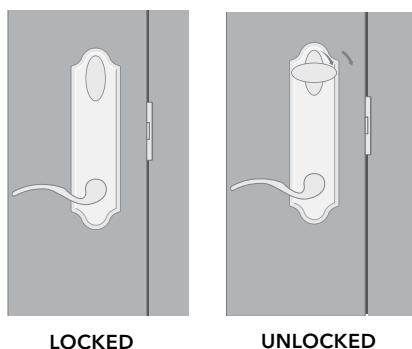
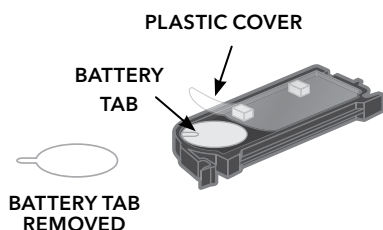
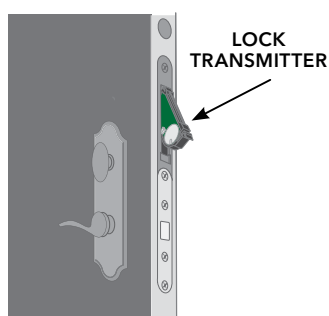
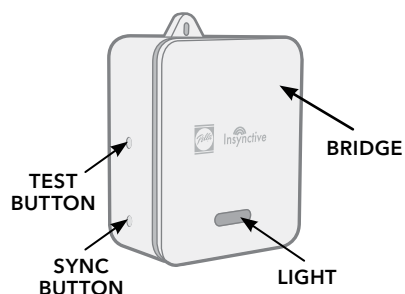

3. Prepare LOCK SENSOR

Remove lock transmitter from door and lift up a corner of the clear plastic cover to expose the battery. Remove and reinsert the battery to place LOCK SENSOR in deletion mode for 2 minutes.

NOTE: If 2 minutes pass without a successful deletion, remove and insert the battery again.

Insert the lock transmitter back into your entry door, close and lock the door, then wait 10 seconds.

The lock transmitter has now learned what type of door it is housed in. You are ready to delete LOCK SENSOR from BRIDGE.

4. Delete LOCK SENSOR from BRIDGE

WITHOUT HOME AUTOMATION (Stand-Alone Mode)

Press and hold BRIDGE Sync button until light begins flashing orange. The Sync button is the bottom button located on the side of BRIDGE.

NOTE: BRIDGE is in sync mode while the orange light is flashing. BRIDGE will remain in sync mode for 2 minutes. BRIDGE will then beep, and orange light will turn off to indicate BRIDGE exited sync mode.

To delete LOCK SENSOR from BRIDGE, lock then unlock your entry door; repeat 2 times within 5 seconds.

Wait for the light on BRIDGE to flash red and beep 3 times. This will indicate a successful deletion.

If LOCK SENSOR deletion is unsuccessful, return to Step 3 and retry the process.

Repeat the above steps until all INTEGRATED ENTRY DOOR SENSORS have been deleted from BRIDGE.

To exit sync mode, press and hold Sync button on BRIDGE until light stops flashing orange.

WITH HOME AUTOMATION

BRIDGE supports two types of home automation system Professionally Installed and Do-it-Yourself (DIY) Z-Wave. For a list of compatible home automation systems and deletion instructions, visit [Insynctive.Pella.com](https://www.insynctivepella.com).

TROUBLESHOOTING

Also refer to **[Insynctive.Pella.com/Support](https://www.insynctive.com/Support)** for more troubleshooting information, including videos, frequently asked questions and reference materials.

PROBLEM	CAUSE AND POSSIBLE SOLUTION
Cannot sync LOCK SENSOR to BRIDGE.	<p>Verify LOCK SENSOR battery is installed correctly and plastic battery tab has been removed. See page 5 for additional information.</p> <p>Remove and reinstall battery to restart sync mode.</p> <p>Move BRIDGE to same room as LOCK SENSOR to ensure that range is not an issue.</p> <p>Verify magnet is in place.</p>
BRIDGE does not beep when entry door is opened.	<p>Verify that BRIDGE chime feature is turned on. See Bridge Product Guide for details.</p> <p>Battery may be too low to operate OPEN/CLOSE SENSOR. Replace battery. See page 13 for additional information.</p> <p>OPEN/CLOSE SENSOR may be out of range. Move BRIDGE closer to OPEN/CLOSE SENSOR. Verify that BRIDGE has power.</p> <p>For Entry Door with Multipoint Lock, verify magnet is in place on door jamb and is aligned with the position of the OPEN/CLOSE SENSOR in the panel.</p>
BRIDGE does not beep when entry door is unlocked.	<p>Verify that BRIDGE chime feature is turned on. See Bridge Product Guide for details.</p> <p>Battery may be too low to operate LOCK SENSOR. Replace battery. See page 14 for additional information.</p> <p>LOCK SENSOR may be out of range. Move BRIDGE closer to LOCK SENSOR. Verify that BRIDGE has power.</p> <p>Verify magnet is in place.</p>
BRIDGE beeps 3 times when entry door is opened.	<p>Battery is low in OPEN/CLOSE SENSOR; replace battery.</p>
BRIDGE beeps 3 times when entry door is unlocked.	<p>Battery is low in LOCK SENSOR; replace battery.</p>

FCC COMPLIANCE AND INDUSTRY CANADA

This equipment has been tested and found to comply with the limits for Class B digital devices, pursuant to Part 15 of the FCC Rules. These limits are designed to provide reasonable protection against harmful interference in a residential installation. This equipment generates, uses and can radiate radio frequency energy and, if not installed and used in accordance with the instruction manual, may cause harmful interference to radio communications. However, there is no guarantee that interference will not occur in a particular installation. If this equipment does cause harmful interference to radio or television reception, which can be determined by turning the equipment off and on, the user is encouraged to try to correct the interference by one or more of the following measures:

- Reorient or relocate the receiving antenna.
- Increase the separation between the equipment and receiver.
- Connect the equipment to an outlet on a different circuit from the receiver.
- Consult the dealer or an experienced radio/TV contractor for help.

Changes or modifications not expressly approved by Pella Corporation could void the user's authority to operate the equipment.

This device complies with Part 15 of the FCC Rules. Operation is subject to the following two conditions: (1) This device may not cause harmful interference, and (2) this device must accept any interference received, including interference that may cause undesired operation.

This device complies with Industry Canada license-exempt RSS standard(s). Operation is subject to the following two conditions: (1) this device may not cause interference, and (2) this device must accept any interference, including interference that may cause undesired operation of the device.

Cet appareil est conforme avec Industrie Canada exempts de licence standard RSS. L'opération est soumise aux deux conditions suivantes: (1) cet appareil ne peut causer d'interférences, et (2) cet appareil doit accepter toute interférence, y compris les interférences qui peuvent causer un mauvais fonctionnement de l'appareil.

Lock Sensor for Entry Door with Deadbolt Lock

FCC ID: SO7-205Y0000

IC ID: 11009A-205Y0000

Lock Sensor for Entry Door with Multipoint Lock

FCC ID: SO7-13N80000

IC ID: 110009A-13N80000

Entry Door Open/Close Sensor

FCC ID: SO7-205Z0000

IC ID: 11009A-205Z0000

LIMITED WARRANTY

A two-year limited warranty comes standard with purchase. For complete warranty details, visit Insynctive.Pella.com/IntegratedSensor.

SOFTWARE LICENSE AGREEMENT AND PRIVACY POLICY

Pella® Insynctive® products are covered by the Pella Insynctive products Software License Agreement and Pella Insynctive products Privacy Policy in effect at the time of sale, which can be found at Insynctive.Pella.com. By installing or using your Insynctive products, you are acknowledging that the Insynctive Software License Agreement and Privacy Policy are part of the terms of sale.

